

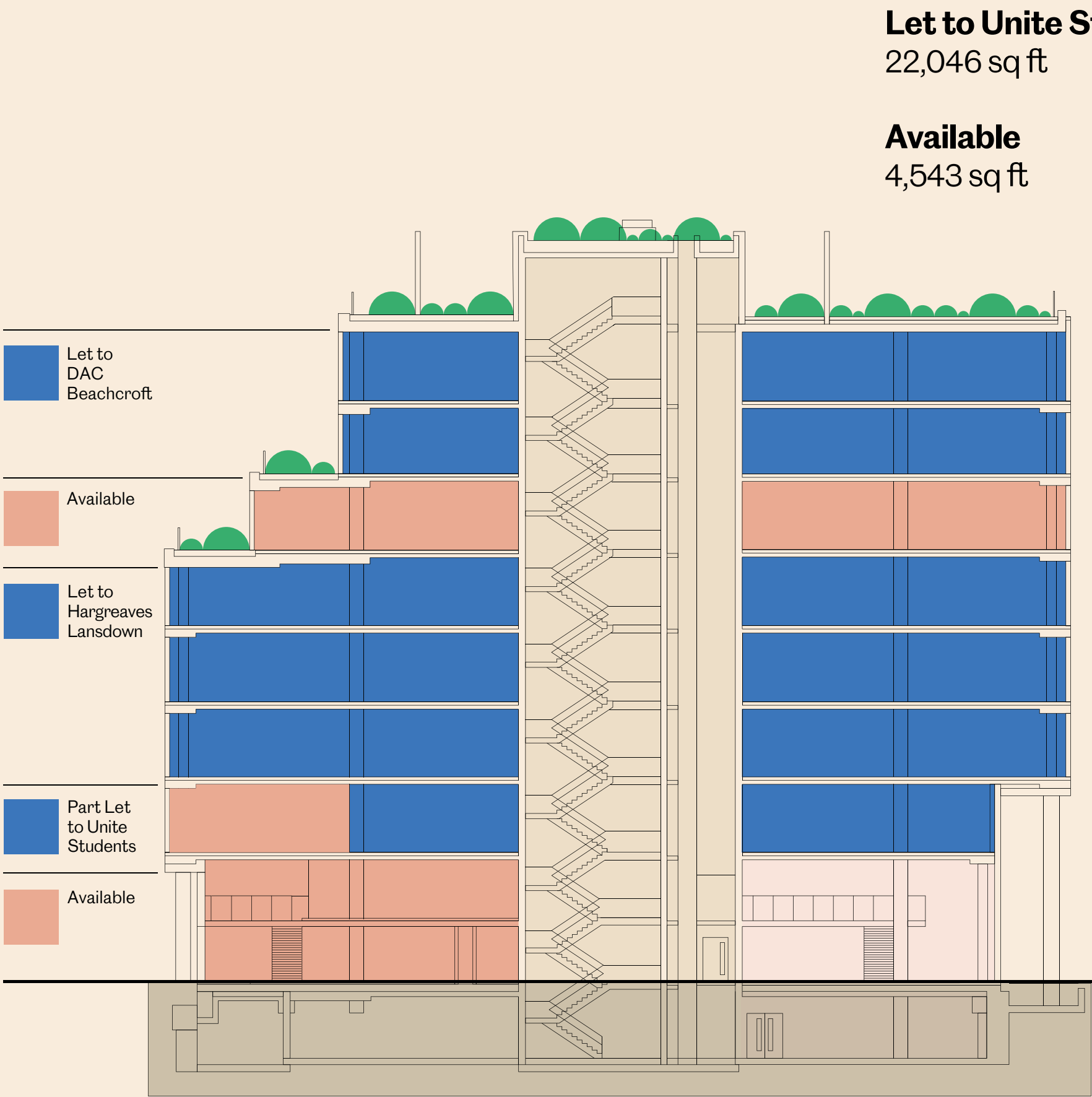

**Welcome
Building[®]**
Bristol

Floor-plates Overview

Schedule of areas



Available Workspace	sq m	sq ft
7th Let	2085.3	22,446
6th Let	2082.8	22,419
5th Available	2443.6	26,303
4th Let	2799.5	30,134
3rd Let	2797.8	30,115
2nd Let	2797.6	30,113
1st Part Let	2048.1	22,046
1st Available	422.1	4,543
Mezz Available	701	7,545
Ground Available	647.4	6,969
Basement	-	-
Total	18,825.2 sq m	202,633 sq ft

Basement

Basement

- 266 cycle space
- 302 lockers
- 26 showers
- 19 car spaces

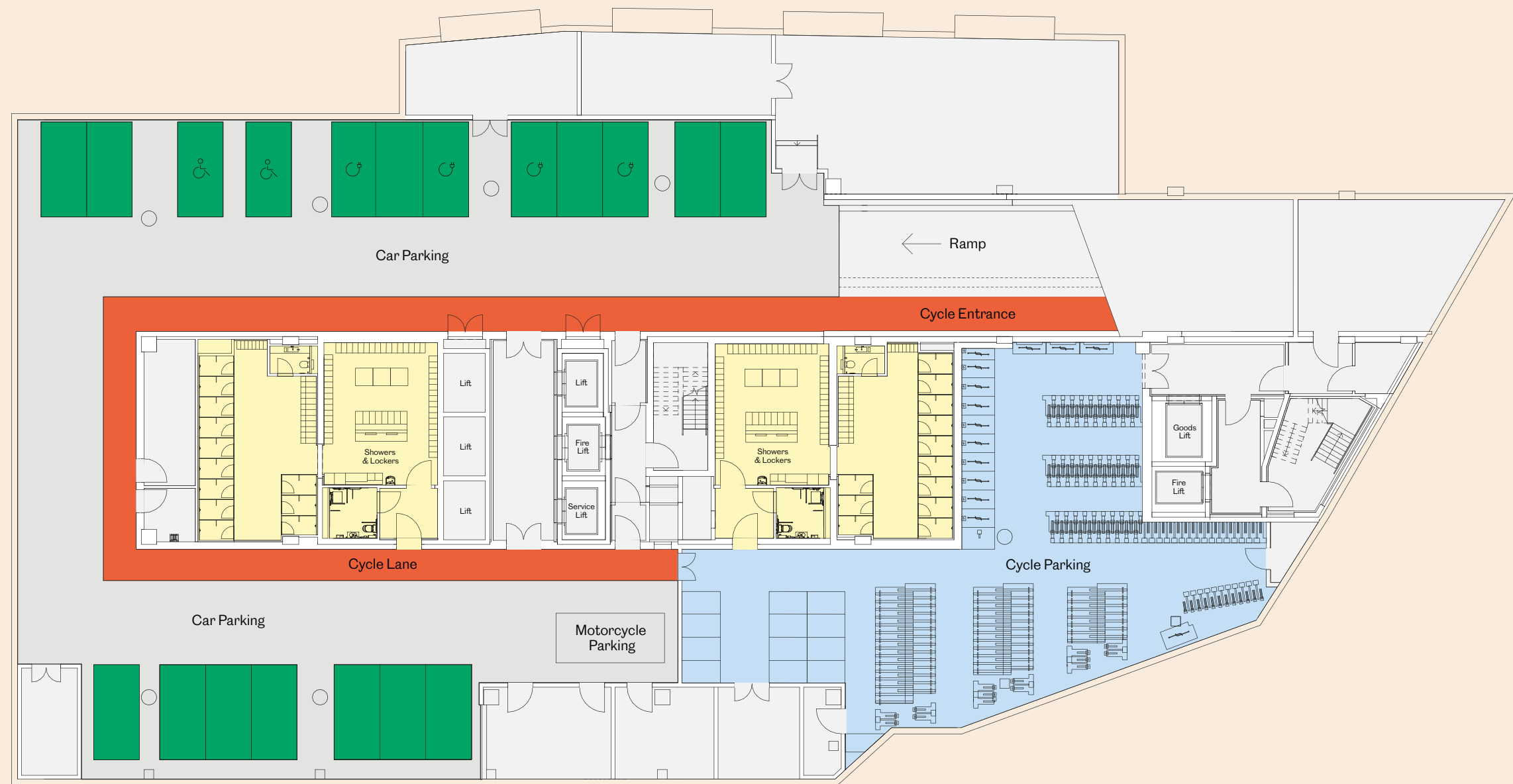

Ground floor

Ground
6,969 sq ft

Terrace
840 sq ft

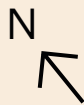
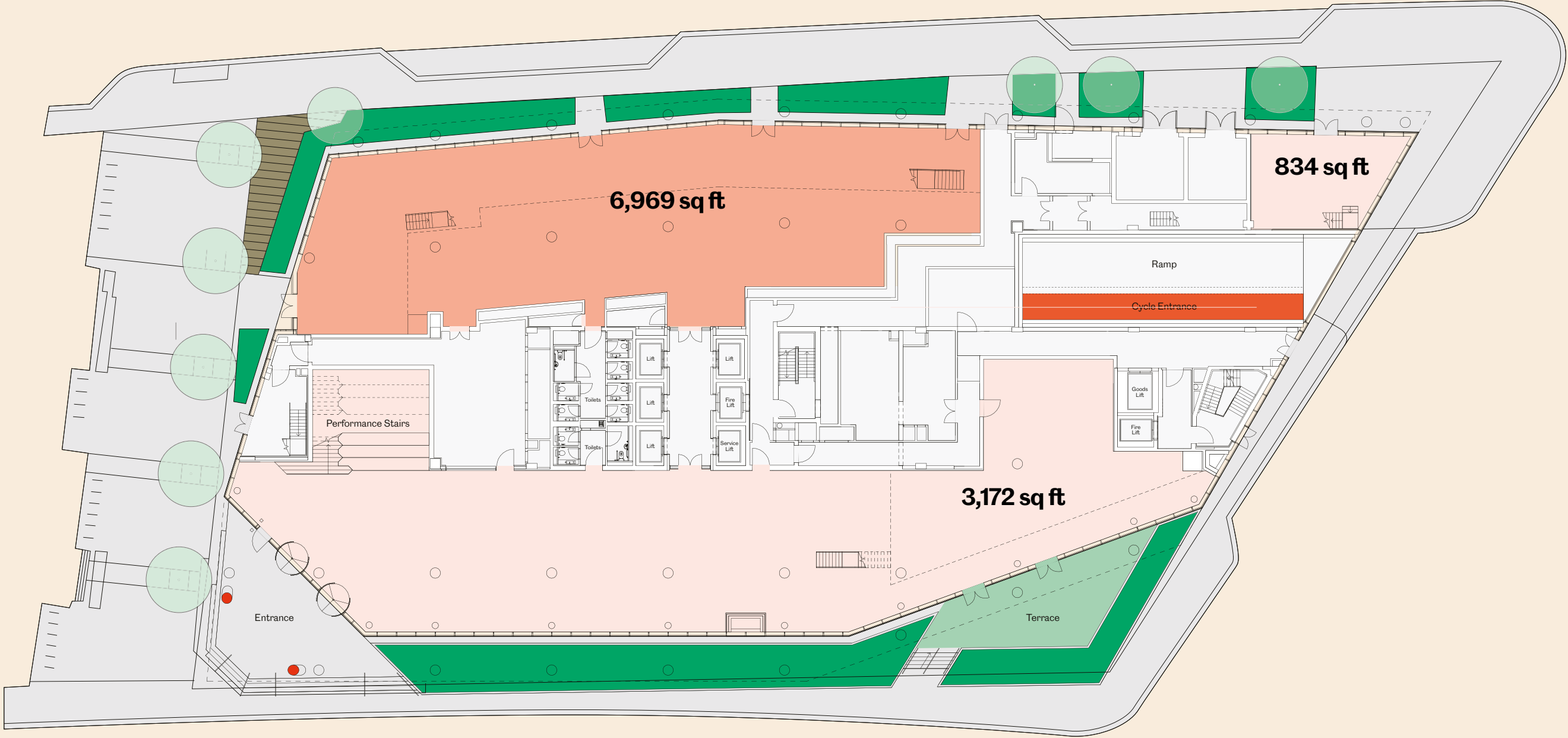

Mezzanine

Mezzanine
7,545 sq ft

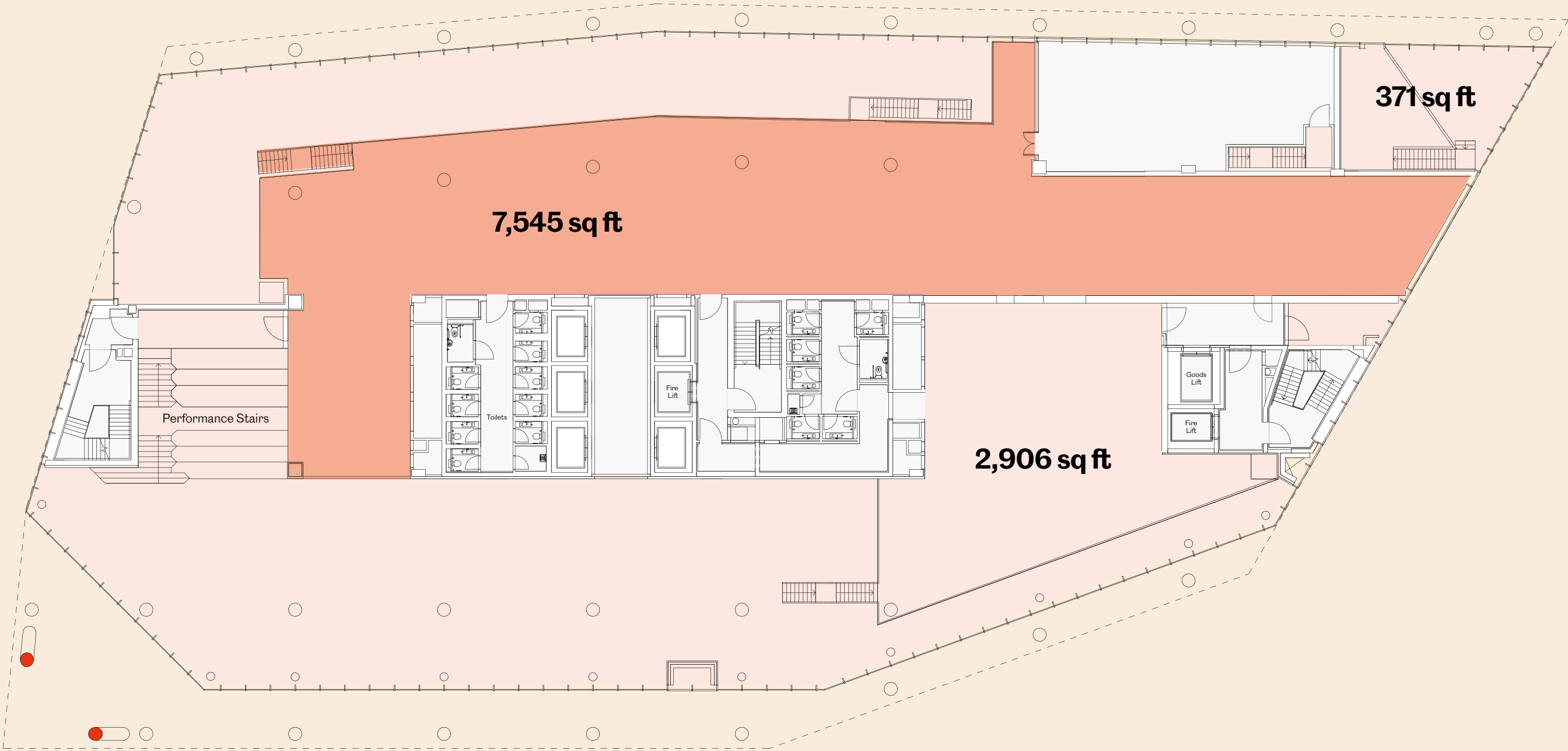

First floor

Let to Unite Students
22,046 sq ft

Available
4,543 sq ft



Second floor

Office
30,113 sq ft



Let to Hargreaves Lansdown



Third floor

Office
30,115 sq ft



Fourth floor

Office
30,134 sq ft



Fifth floor

Office
26,303 Sq ft

Terrace
3,068 sq ft

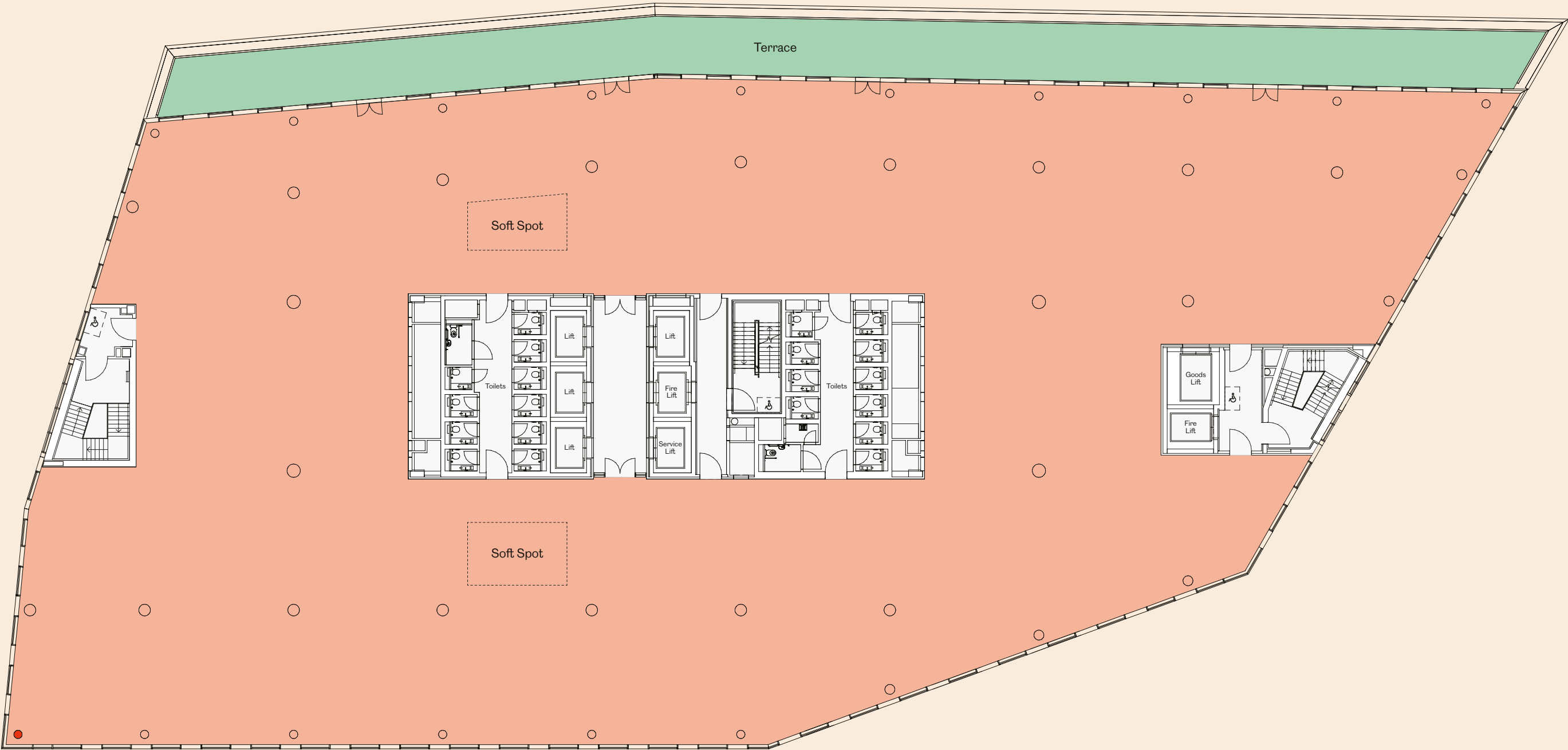

Sixth floor

Let to DAC Beachcroft

Office
22,419 sq ft

Terrace
3,121 sq ft

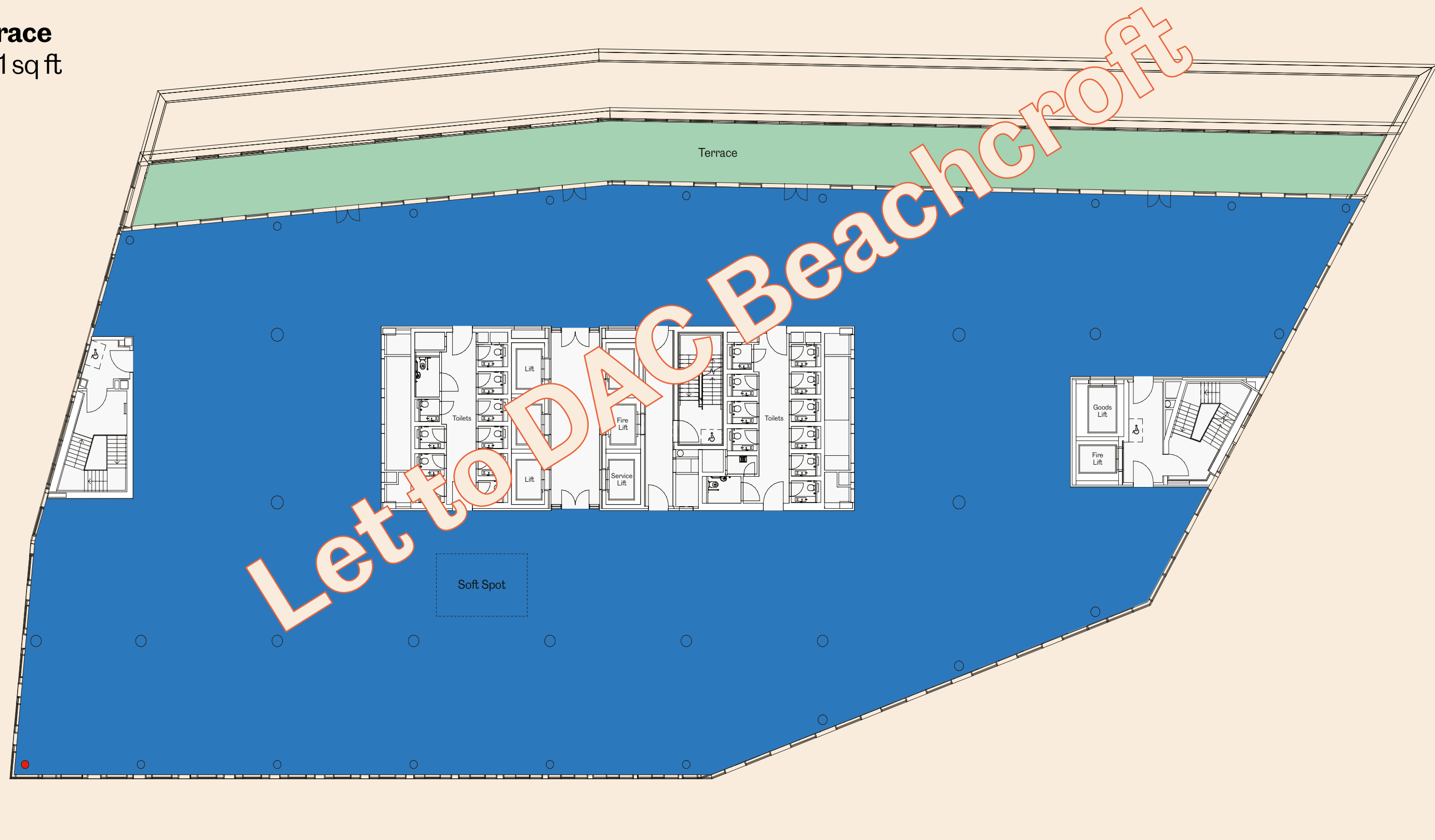

Seventh floor

Let to DAC Beachcroft

Office
22,446 sq ft

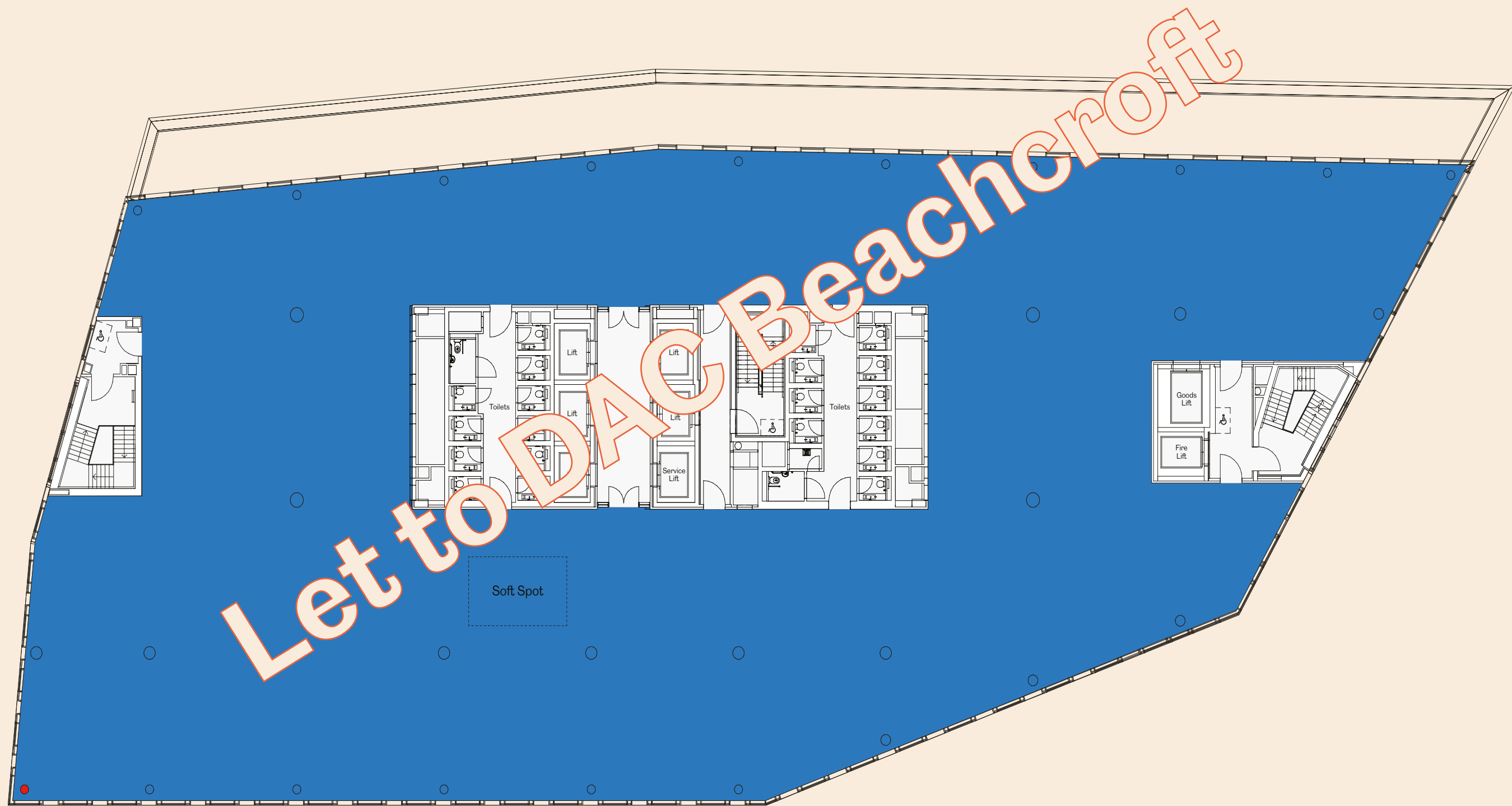

Open plan

- Area

2,754 sq ft
- Occupancy

1/8 sq m
- Desks

338
- Other work stations

19
- Cellular spaces
(Meeting, office, quiet Rm)
- Teapoint / break-out
- Print copy
- Other workspace
- Other workspace
- High loads areas
- Proposed soft-spots



Part cellularisation

- Area

2,754 sq ft
- Occupancy

1/12 sq m
- Desks

277
- Other work stations

18

- Cellular spaces
(Meeting, office, quiet Rm)

Teapoint / break-out

Print copy

Other workspace

Other workspace

High loads areas

Proposed soft-spots

Office

21

Total

316



North/South tenancy split with stair



If you'd like to find out more you can
get in touch with the details below.



**A Leading Commercial
Real Estate Developer**
trammellcrow.com



**Real Estate Investment
Management**
tristancap.com



Simon Price
sprice@alderking.com
+44 (0) 7990 891021



Andy Smith
andy.smith@knightfrank.com
+44 (0) 7443 983253