

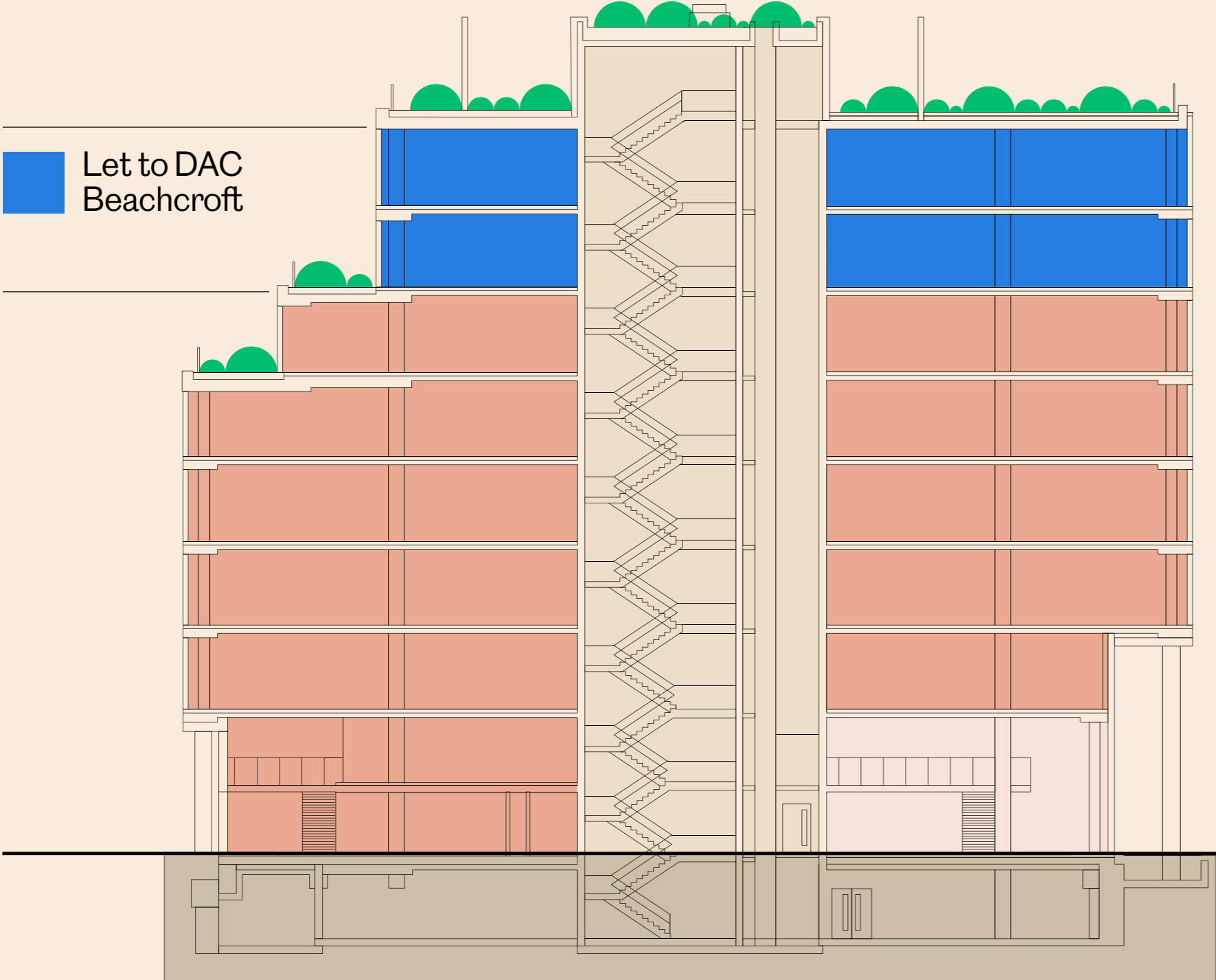

**Welcome  
Building<sup>®</sup>**  
Bristol

**Floor-plates  
Overview**

# Schedule of areas



Available Workspace	Sq M	Sq Ft
7th	2085.3	22,446
6th	2082.8	22,419
5th	2443.6	26,303
4th	2799.5	30,134
3rd	2797.8	30,115
2nd	2797.6	30,113
1st	2504.7	26,960
Mezzanine	1005.5	10,822
Ground	1019.6	10,975
Basement		-
<b>Total</b>	<b>19,536.4 Sq M</b>	<b>210,287 Sq Ft</b>

# Basement

Basement

266 cycle space

302 lockers

26 showers

19 car spaces



# Ground floor

## Ground

10,975 Sq Ft

## Terrace

840 Sq Ft

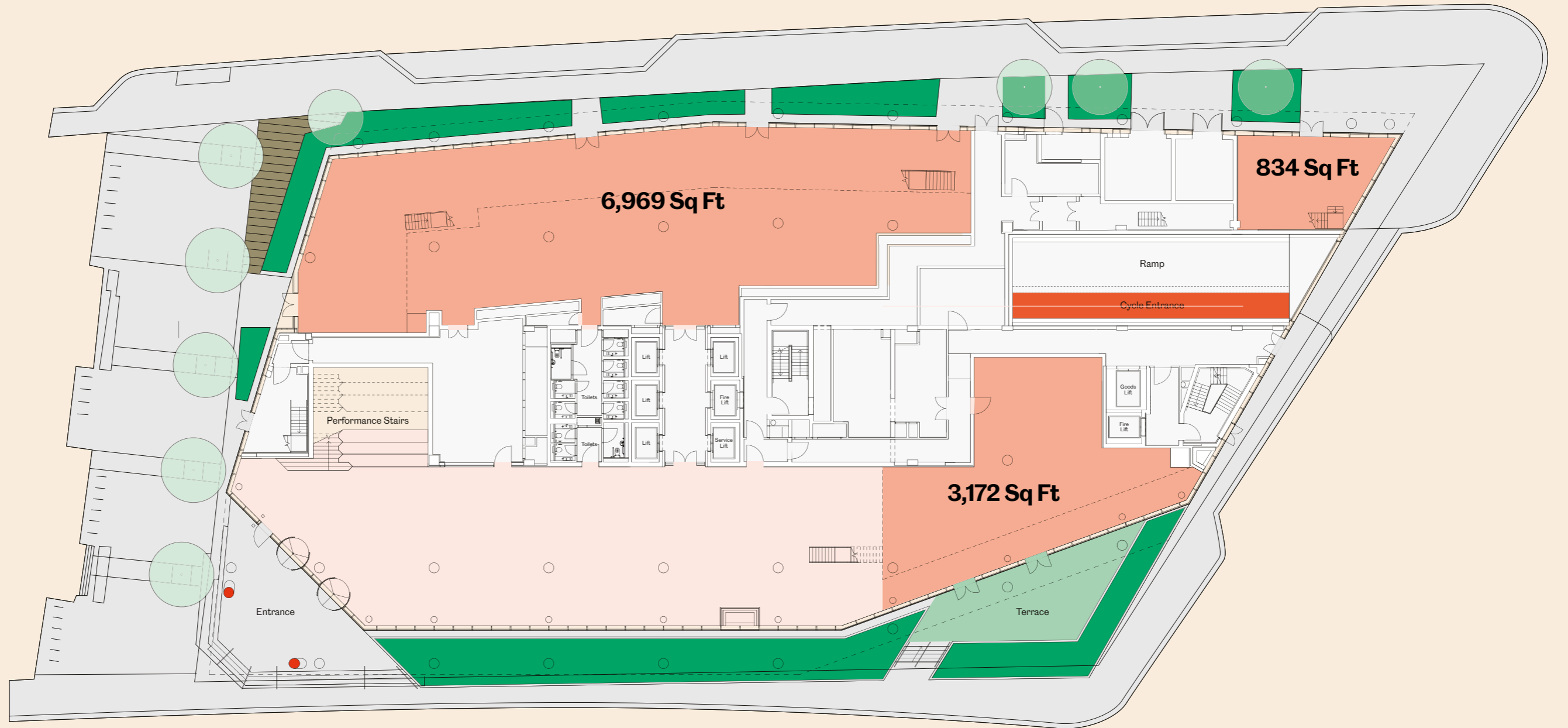



# Mezzanine

**Mezzanine**  
10,822 Sq Ft

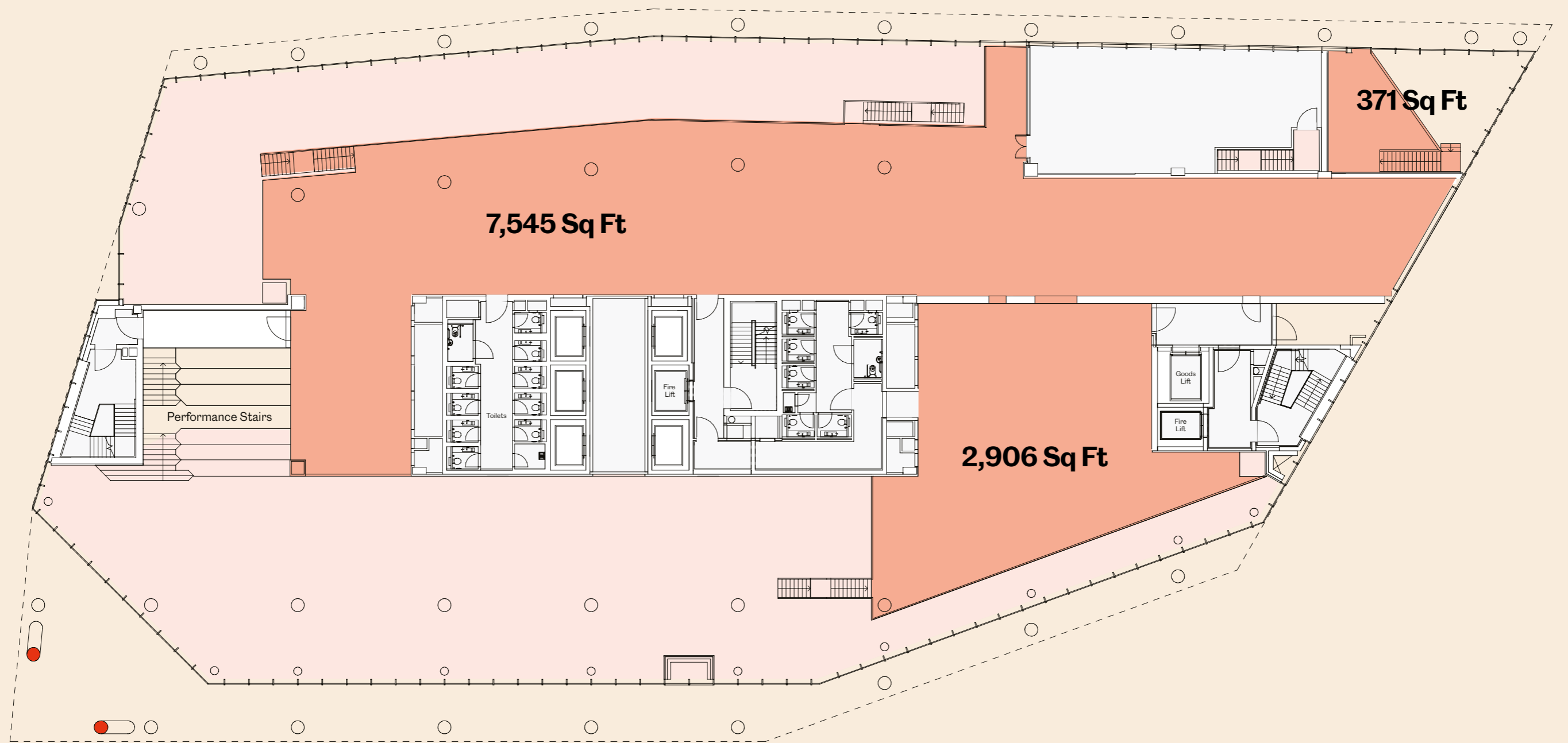

# First floor

**Office**  
26,960 Sq Ft

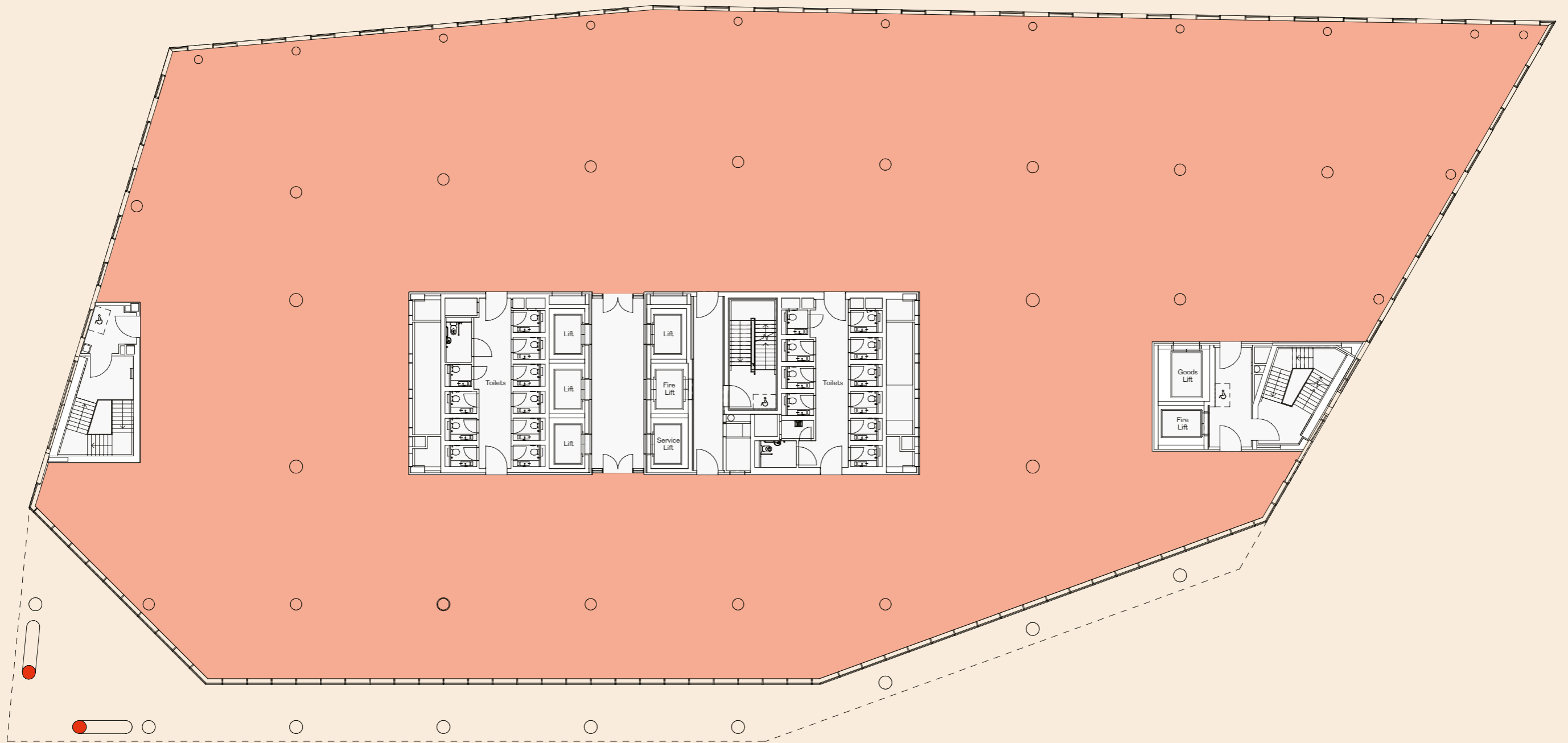

# Second floor

**Office**  
30,113 Sq Ft

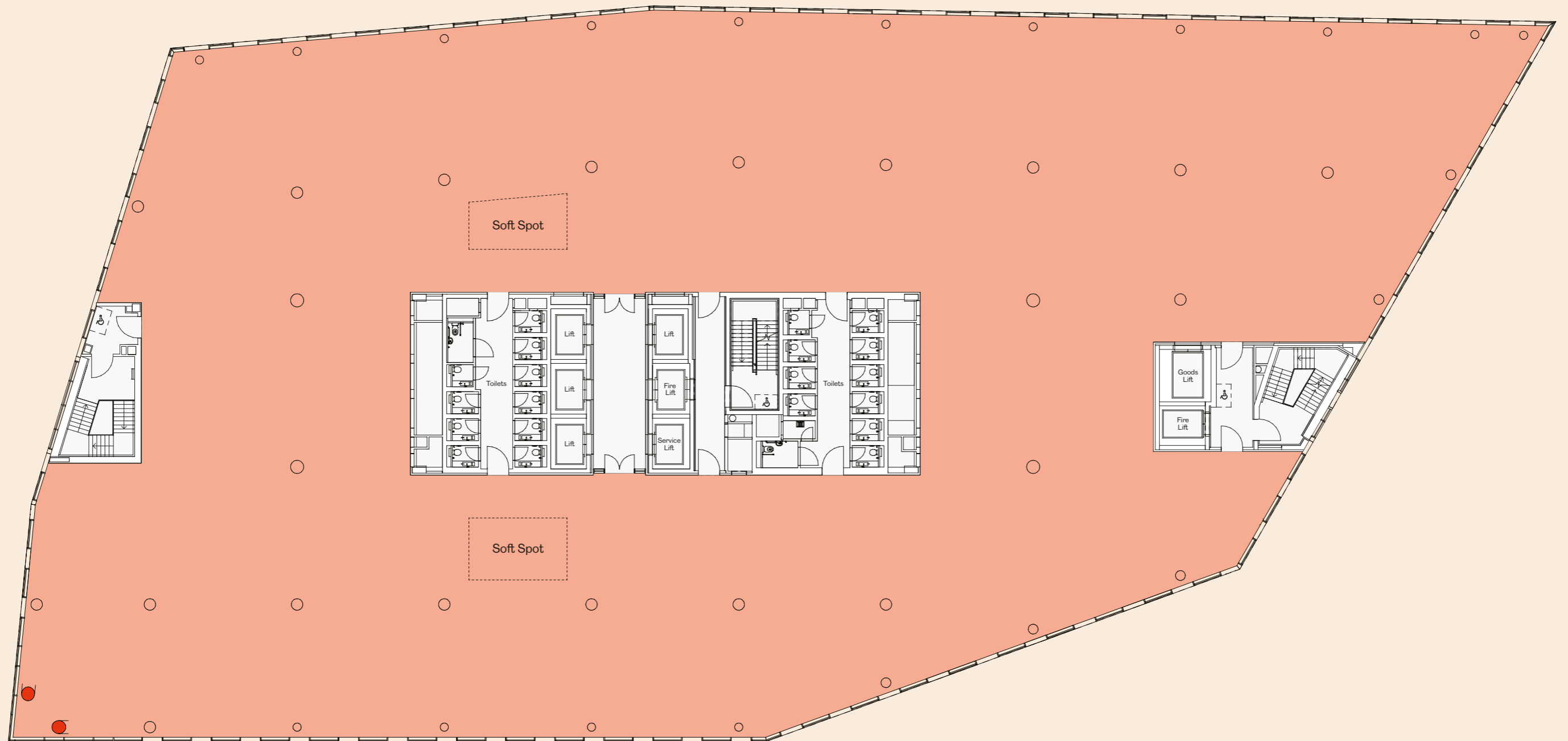

# Third floor

**Office**  
30,115 Sq Ft

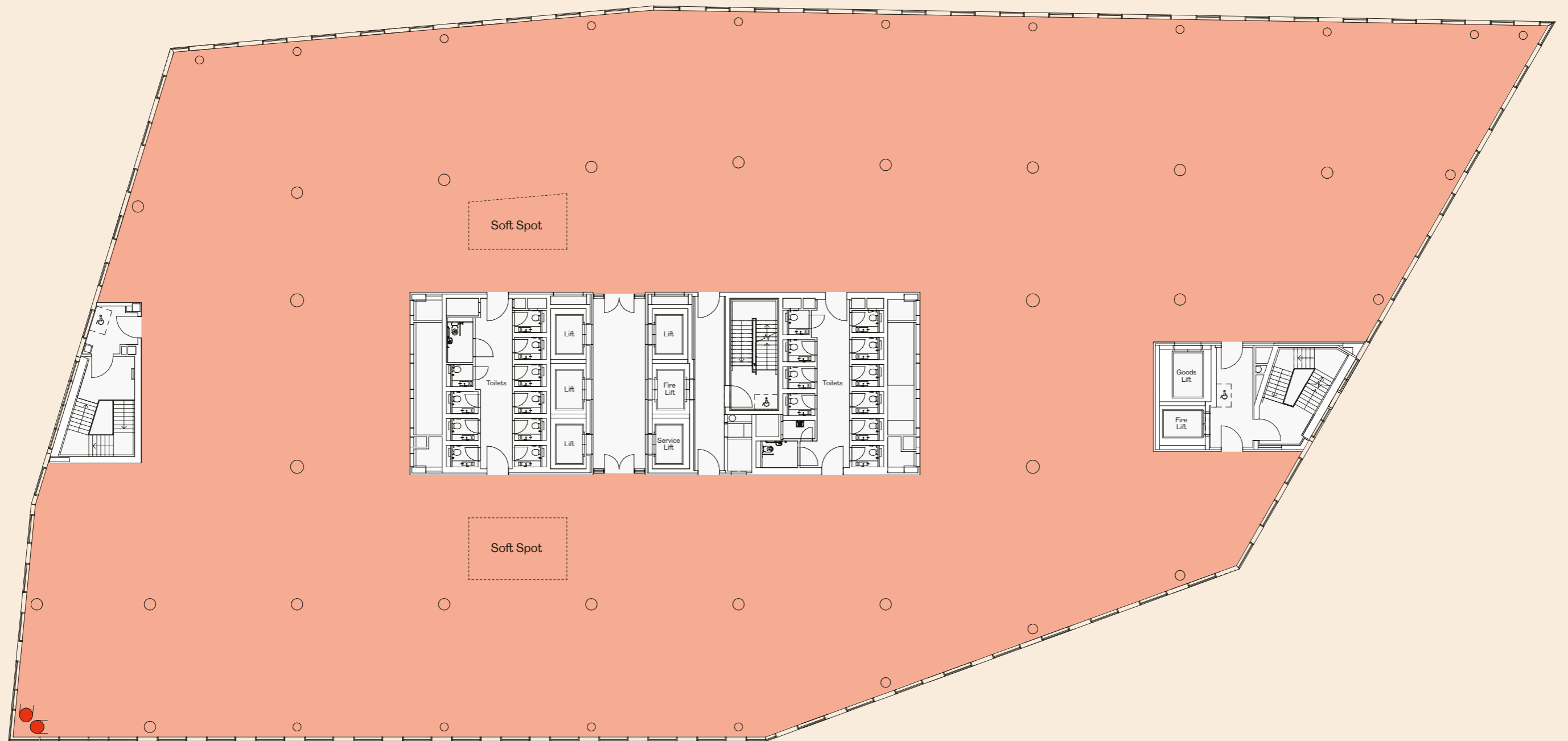

# Fourth floor

**Office**  
30,134 Sq Ft

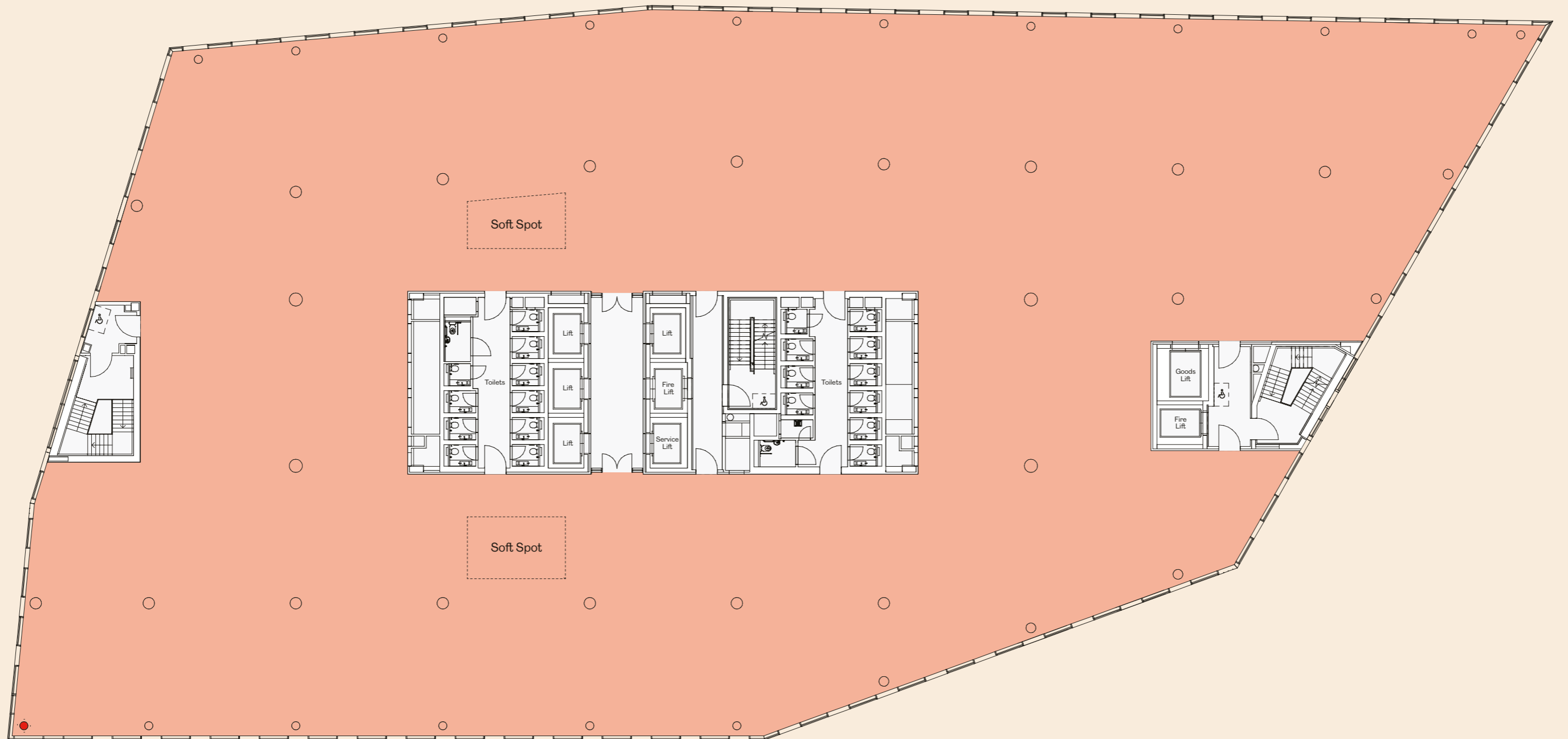

# Fifth floor

## Office

26,303 Sq Ft

## Terrace

3,068 Sq Ft

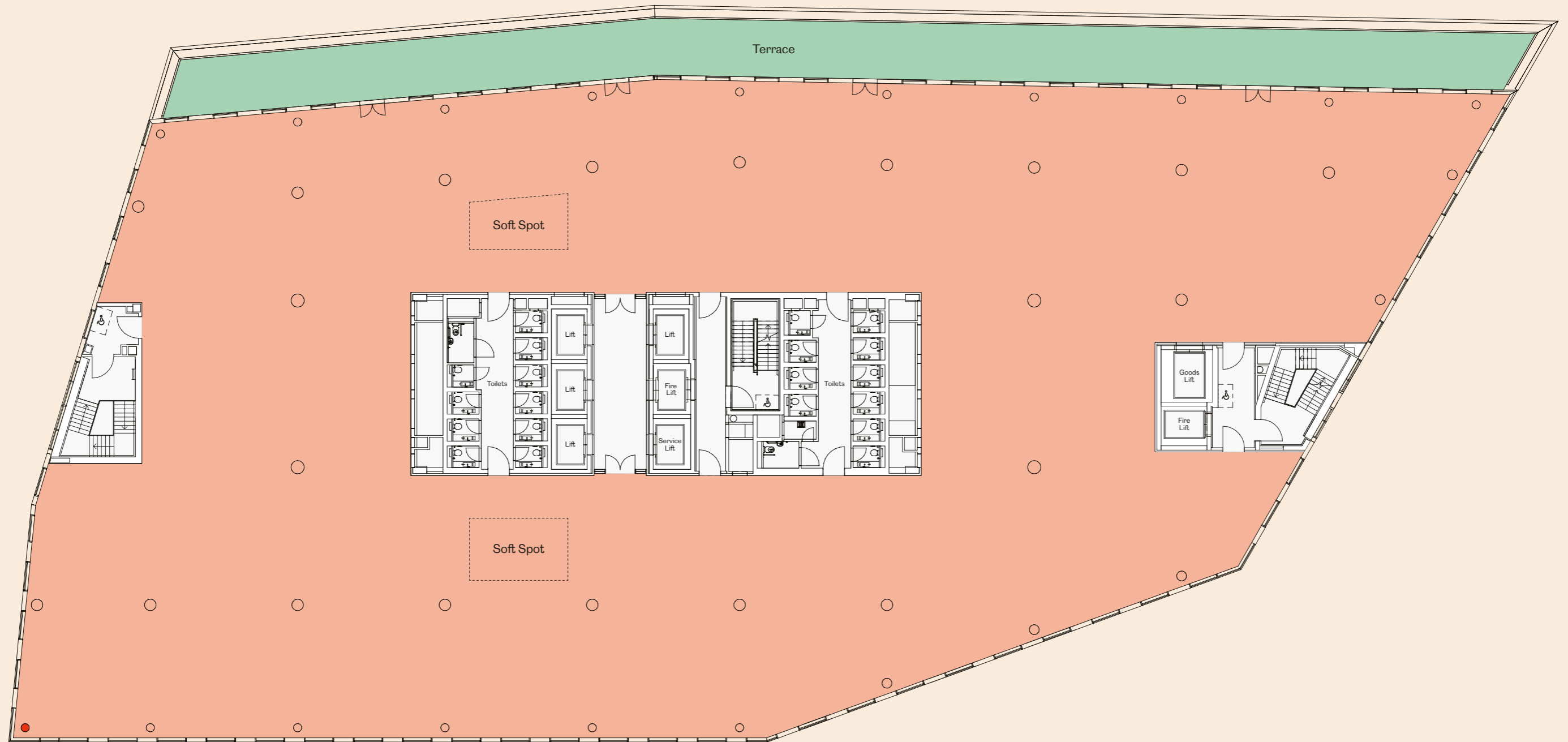

# Sixth floor

Let to DAC Beachcroft

## Office

22,419 Sq Ft

## Terrace

3,121 Sq Ft

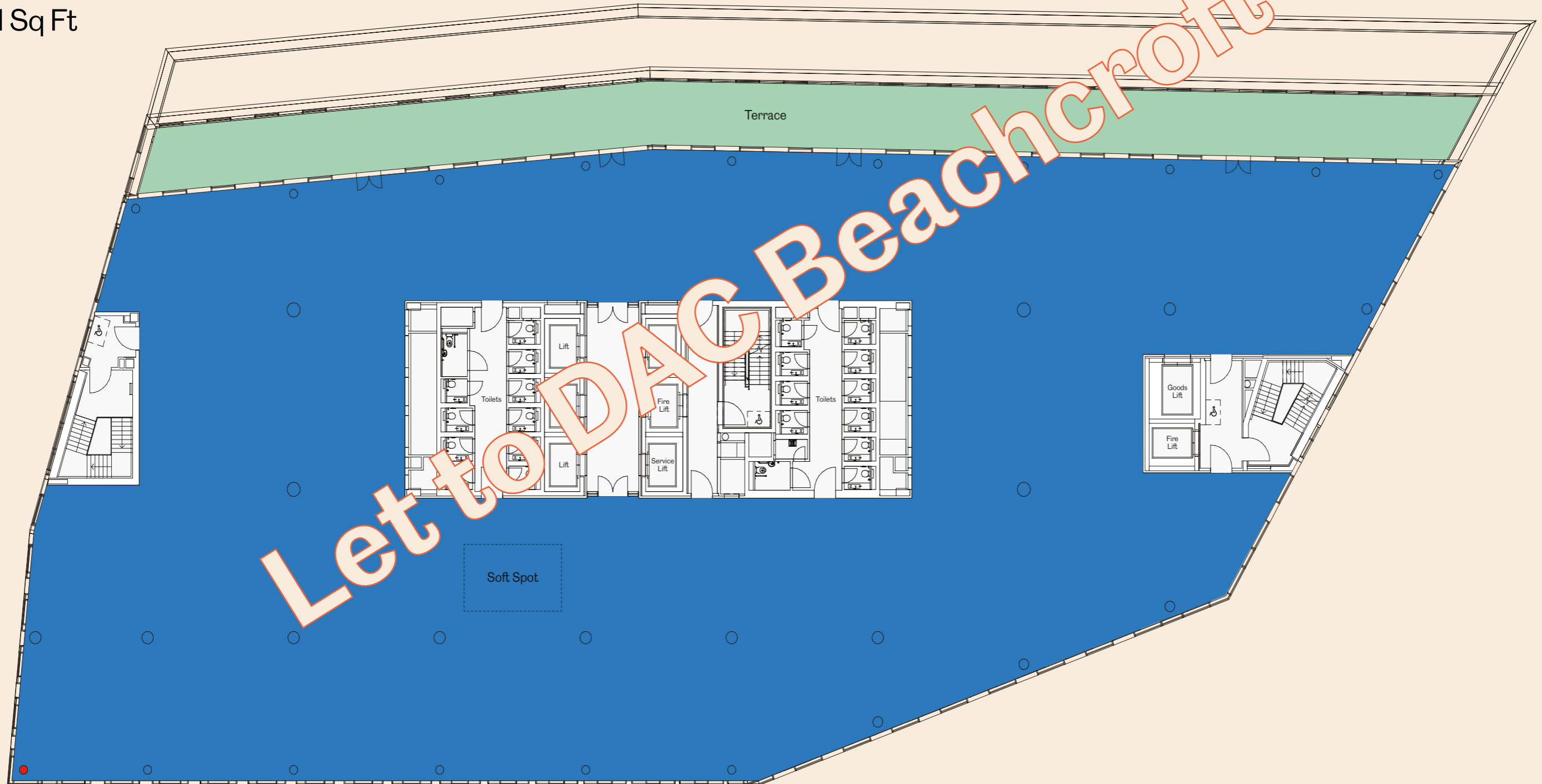

# Seventh floor

Let to DAC Beachcroft

Office

22,446 Sq Ft

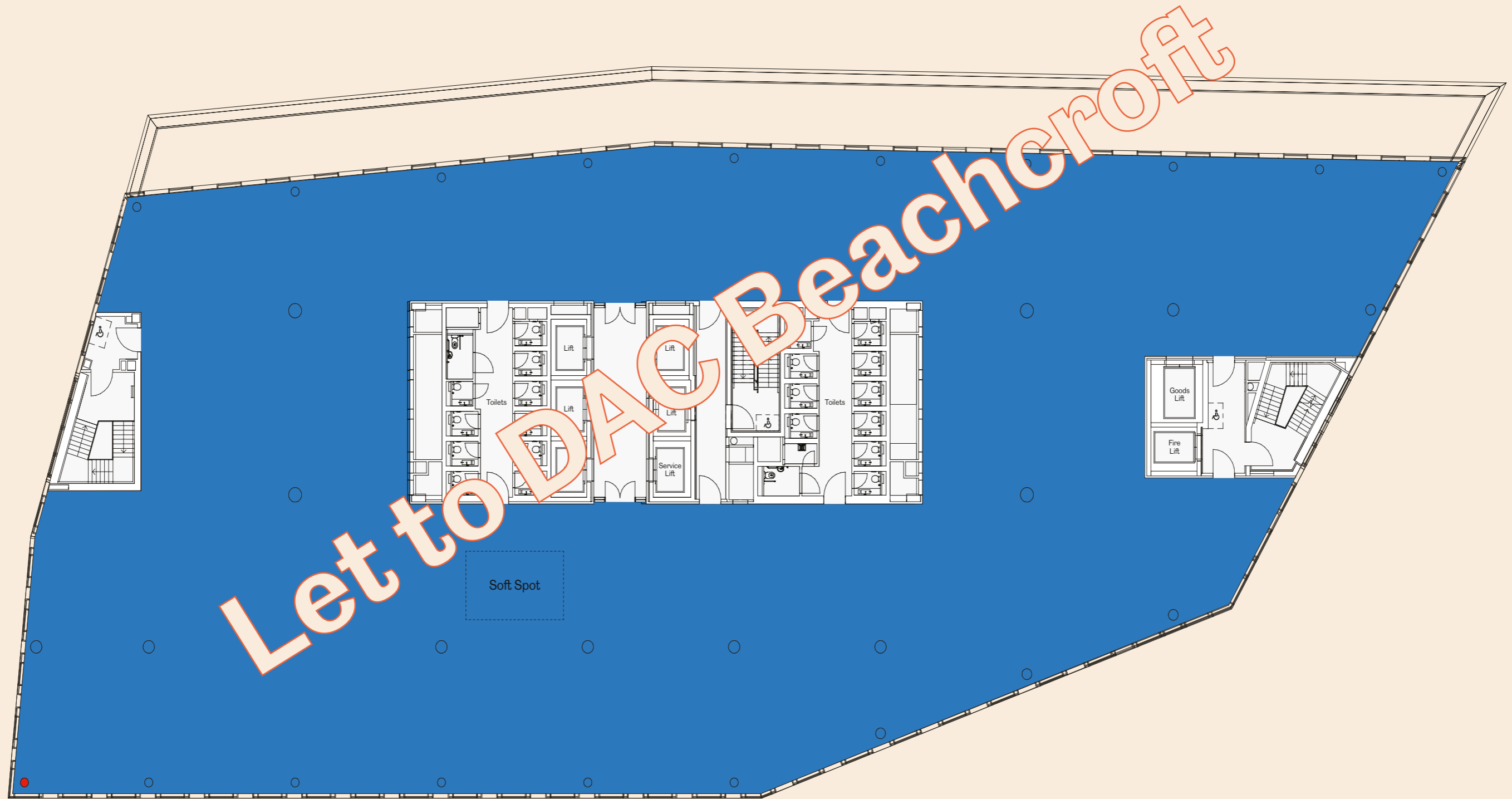



# Open plan

**Area**  
2,754 Sq Ft

**Occupancy**  
1/8 Sq M

**Desks**  
338

**Other work stations**  
19

**Total**  
357

- Cellular spaces  
(Meeting, office, quiet Rm)
- Teapoint / break-out
- Print copy
- Other workspace
- Other workspace
- - - High loads areas
- - - Proposed soft-spots



# Part cellularisation

**Area**  
2,754 Sq Ft

**Occupancy**  
1/12 Sq M

**Desks**  
277

**Other work stations**  
18

**Office**  
21

**Total**  
316

- Cellular spaces (Meeting, office, quiet Rm)
- Teapoint / break-out
- Print copy
- Other workspace
- Other workspace
- High loads areas
- Proposed soft-spots



# North/South tenancy split with stair

North	South
<b>Area</b> 1,490 Sq Ft	<b>Area</b> 1,225 Sq Ft
<b>Occupancy</b> 1/8 Sq M	<b>Occupancy</b> 1/8 Sq M
<b>Desks</b> 181	<b>Desks</b> 139
<b>Other work stations</b> 23	<b>Other work stations</b> 16
<b>Total</b> 204	<b>Total</b> 155

- Cellular spaces (Meeting, office, quiet Rm)
- Teapoint / break-out
- Print copy
- Other workspace
- Other workspace
- - - High loads areas
- - - Proposed soft-spots



**If you'd like to find out more you can  
get in touch with the details below.**



**A Leading Commercial  
Real Estate Developer**  
trammellcrow.com

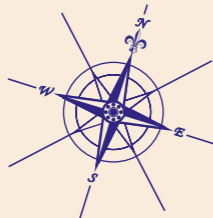

**TRISTAN**  
CAPITAL PARTNERS

**Real Estate Investment  
Management**  
tristancap.com



**Simon Price**  
sprice@alderking.com  
+44 (0) 7990 891021



**Andy Smith**  
andy.smith@knightfrank.com  
+44 (0) 7443 983253